



SPACE UK

EDINBURGH FESTIVAL FRINGE

Prospectus

2018

Welcome to theSpaceUK, the largest producers of live performance at the Edinburgh Festival Fringe. We're very pleased that you are considering our venues to showcase your work at the 2018 festival. And, we look forward to giving you the very best platform to do just that.

theSpaceUK has a well-established Fringe history. Since producing our first festival in 1995 and spending every subsequent August in Edinburgh, our passion has only grown stronger. At our heart is our ethos, embedded in the very roots of the Fringe, as a platform for the unknown artist. We curate an 'open' programme - we believe that anyone who wants to bring a show to the Fringe should be given the opportunity to do so.

Given that we've been running venues at the festival for all these years we like to think we know what we are doing, so we can assure you that whatever your level of work you are in very able hands. These days we are fortunate to produce the largest new writing programme on the Fringe and with that comes huge diversity. We are very proud of that. But even though we have grown and developed and now produce many award winning shows, we are still very much an all-inclusive venue. We offer not only a great and established platform but we understand what its like to bring a show for the first time or for a short run.

Our teams are experienced and professional theatre people who not only love the arts but love the Fringe too. We'll make sure your show has the best possible platform and we'll happily hold you hand through the process.

We are also very transparent, we tend to adopt the 'all inclusive straight hire' deal, this means that you pay us a defined amount and we facilitate all else in the venue, you also get to keep all your box office receipts and you collect these on a daily basis.

We do hope that you find your Fringe home with us, we have many shows that return year after year and for us this is a great testament not only to our fair and honest way of producing and presenting our venues but for the very reason we're here in the first place - to bring shows to the Edinburgh stage.

We look forward to working with you.

Charles Pamment

Creative Director, theSpaceUK

bookings@thespaceuk.com • 0131 510 2399 • 07976 785 718



Our Programme

Our focus is on programming a wide range of performance genre. We will programme established theatre as well as seeking out and giving new and developing work an opportunity to blossom on the Edinburgh stage. We have a strong belief in the ethic of the Fringe as a platform for the unknown artiste and focus very much on advising, promoting and developing the acts that perform with us in Edinburgh.

Whatever anyone says, we all like a good award and we are of course very pleased and proud to be able to shout about these on a regular basis. It's always great to host shows that win awards. And, any venue worth their salt should be pleased to talk about these and to give you a list, these really define the level of work the venue is known for producing.

The awards won by our companies over the years, many by unknown or new acts reflects this pedigree. But you don't have to be told you're the best or brightest to simply get it on and see where it goes on the Fringe...quite often that journey surprises many!



Recent History: Fringe 2017

What an incredible year! Edinburgh Festival Fringe 2017 was simply fantastic at theSpaceUK.

Record audience figures (up over 20% on 2016 to over 140,000 audience members), a constant flow of sell-out shows, 4 and 5 star reviews and lots of features and award nominations.

A whopping number of our shows managed to attain the highly sort after 'sell out' laurel awarded by the fringe society.

"No other venue at the Edinburgh Festival Fringe offers quite as much diversity as theSpaceUK. They have quietly become the largest player whilst still remembering the very ethos of the Fringe." *Pete Shaw, Editor, 'Broadway Baby'*

Press and Marketing Support

Our press and marketing team is in full swing from May to August working on behalf of all our performing companies. We facilitate the sharing of company press releases to both industry and the wider media, liaison with the shows press team, PR agents and press officers to co-promote the show and to manage and site reviews.

We have strong and established relationships with the media, like many Fringe venues we partner with Broadway Baby who prioritise our shows for review. In 2017 95% of our shows were reviewed and in actuality they offer us a little more with a pre-Fringe feature preview for many of our companies too.

We also have ongoing relationships with Fringe stalwarts including Three Weeks, Fest, Fringe Review, The Stage, The Scotsman, ScotsGay and several

other industry outlets who review a large percentage of our shows.

We are also very much on the radar of the Broadsheets and Sunday supplements and enjoy an array of features and reviews, recently in The Scotsman, The Times, The Daily Mail & Express, The Independent, The Daily Telegraph, The Evening Standard, Metro and even The Sun.

The Next Step

Our teams are easily accessible and willing to assist. Ring us directly on 0131 510 2399 or 07976 785 718 between 0900 - 2000, including weekends.

Alternatively you can fill in our simple form on our website: <http://www.thespaceuk.com/edinburgh-venues/booking-form/>

We will come back and talk to you about your show and look to make you a formal offer without delay.

Performing at theSpaceUK's Venues

As part of your hire, you have sole use of the theatre from us during your slot for one, two or three weeks. If you're performing in week one (August 6th to 11th 2018), you also have the option of performing some previews in week zero (Friday August 3rd to Saturday 4th 2018). We offer these shows on a complimentary basis to performing companies performing in week one.

The hire period includes your get-in and get-out, so please remember that a 60 minute slot, for example, is not long enough for a 60 minute show! The fringe model is such that shows run back to back in each theatre, with this in mind we recommend factoring in at least 5 minutes get-in/out time per performance. i.e.: A 60 minute slot is often long enough for a 45-50 minute show requiring simple technical aspects.

We do of course cater for shows that run from 30 minutes to 2 hours and incorporating all scales of technical complexity, so please talk to us directly about your show and we can advise on slot lengths to suit your show and get-in requirements.

We believe that the artiste/s is the talent and to that end if a show does well then the artiste/s should reap the reward. Our pricing model is simple: We offer the 'straight hire all-inclusive' model, which means the performing company pays one defined fee. This fee covers the whole package for your show including a fully facilitated and licensed theatre, FOH and box office support, technical support, audience management, show inclusion on the venue website and in the venue brochure, full press office and marketing support.

We are connected to the Fringe's Box Office and on-line sales platforms just like any other venue. Once on-site, our venue box offices handle walk-in customers. Not only do we pay you the proceeds from your cash sales daily during the Festival, but we don't charge you the 4% commission that Fringe sales attract.

Our tickets can go on sale from January 1st or whenever you register your show with the Fringe on the Fringe Box Office website. We find this very useful and means our shows are on sale nice and early. In recent years we've made 10-15,000 ticket sales by mid-May.

It's a tried and tested format and very much one of the reasons why we have a huge percentage of companies returning to work with us year on year.

Of course, we're flexible if you want to talk about a box office split or wish to discuss prices further, so do please feel free to contact us directly to discuss.

When to Perform

Talk to us about which kind of time slot may suit your work, we have lots of experience of working with all genres so can give you examples for what works well where.

We are very easy with working with shows wanting to come for shorter runs, not all can afford or fit in a 3 week run in Edinburgh and we have a good percentage of shows that come and perform for one or two weeks or even just a few days.

Do please talk to us about this.

Slot Prices

We offer you a bespoke deal to perfectly suit your show's specific requirements so we don't publish a price list. Give us a call or e-mail to discuss, and we can organise a quote for you very quickly.

The rental fee is payable in 3 simple instalments. (20% on agreement, 30% in May, 50% in July).

Company Privileges

Every member of your company will receive their own highly valued *SpacePass*. Unique on the Fringe, this gives our companies' members access to all our shows on a stand-by basis.

This is mutually beneficial as it allows companies to support each other's shows during the early days of their run. It is also a fantastic way to see shows at the Fringe on a budget; we produced some 370 shows in 2017 and access to see them benefits everyone especially those shows with large casts or from Schools and Universities.

Your *SpacePass* also gives you a chunky discount on food and drinks in all our venues, these include the courtyard bars at theSpace @ Surgeons Hall, our *Prosecco Bar* on Hill Square, our open air bar adjacent to our theatres on Niddry St as well as the bars at theSpace @ Jurys, SpaceTriplex and at *Café 1505* on Nicholson Street.

theSpaceUK's All-Inclusive Package

- Sole use of the theatre for the period of your slot.
- Box Office support, dealing with walk-in sales and advance reservations.
- Ticket management by our Box Office teams, connected to the Fringe Box Office monitoring daily sales and ensuring that any available tickets for your shows are appropriately balanced between the Fringe Box Office and our own.
- Tickets go on sale as soon as you confirm your show booking - from Jan 1st 2018.
- Constant support from our experienced production team from the time of booking to your get out.
- PRS background music cover in all our theatres.
- Full theatre licence cover.
- Full on-site technical management by our experienced team of Venue and Box Office Managers during your run.
- We give you full technical control - we let your own technicians operate your performances, but contact us if you require an operator.
- Technical rehearsal period one-and-a-half times your slot length.
- A 60 word description of your show in 15,000 venue brochures and on our website.
- Inclusion in three venue press releases (July/ August 2018).
- Media access support from our Press Office.
- Advertising on venue hoardings outside our theatres. We have various hoardings outside our venues in Jeffrey St, Nicholson Street and Niddry Street and 'A' boards for flyers on the Royal Mile.
- Licensed bars.
- Unique access to 8 central box office sites to assist in selling your tickets.
- SpacePasses for all your company members: These give complimentary access to all shows across our venues (if the show hasn't sold out) on a stand-by basis.



For availability and bookings please ring our programming team on 0131 510 2399 or 07976 785 718. Alternatively, fill in the application form at www.thespaceuk.com or simply e-mail bookings@thespaceuk.com with your show details and we'll come back to you asap. For technical queries email the production team at production@thespaceuk.com

Our Locations

Don't be hoodwinked by anyone that says location isn't crucial in Edinburgh, it most certainly is!

We offer companies unrivalled venue locations right at the centre of the Fringe with eleven theatres located on the Royal Mile and seven spaces at our hub minutes walk away at theSpace @ Surgeons Hall.

We boast seven central box offices. Show posters, flyers and tickets are available in all these locations. With over 140,000 audience members passing through our box offices each August we offer unrivalled access to Fringe audiences. Added to this is our branding and marketing presence across the city, this gives our venues and shows optimum visibility.

Our aim is to offer the most suitable environments for companies to present their work. We don't put theatres in dusty schools on side streets or temporary tents venues or in buildings that have creative restrictions or limitations on what performers can say and what audiences can and can't do.

We've designed our theatres to give a wide range of choice to performing companies and these fit any requirement or genre. You will find that our spaces are a little different, the stage sizes versus auditorium size may be a little larger than usual, this is because the Fringe is a show case environment and we want to give the show as much opportunity to showcase their work to the best of their ability

Our ethos is very much to give performing companies an affordable, safe and totally professional platform. And, for their audiences, we create a polished but affordable environment with easy access to bars, restaurants and all that central Edinburgh has to offer.

Jeffrey Street	7
Venue 45 (45)	8
Jurys: Main Theatre (260).....	9
Jurys: Studio Theatre (260).....	10
theSpace on the Mile (39)	11
Space One	12
Space Two	13
Space Three	14
theSpace on Niddry (9)	15
Lower Theatre	16
Upper Theatre	17
theSpace on North Bridge (36)	18
The Argyll Theatre.....	19
The Perth Theatre	20
The Fife Theatre	21
theSpace @ Surgeons' Hall (53)	22
Theatre 1	24
Theatre 2	25
Theatre 3	26
Grand Theatre	27
theSpace Triplex (38)	28
Big	29
Studio	30
theSpace @ Symposium Hall (43)	31

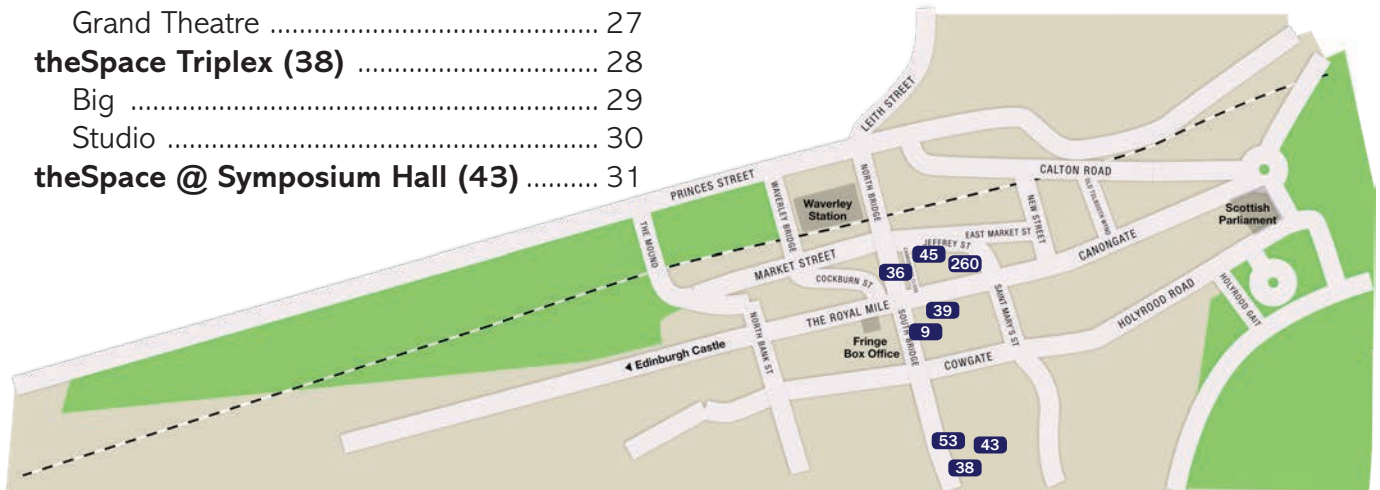

For availability and bookings please ring our programming team on 0131 510 2399 or 07976 785 718. Alternatively, fill in the application form at www.thespaceuk.com or simply e-mail bookings@thespaceuk.com with your show details and we'll come back to you asap. For technical queries email the production team at production@thespaceuk.com

Jeffrey Street (Venue 45 & Jurys)

The Space @ Venue 45

theSpaceUK have managed Venue 45 since 1995 - it has been a Fringe venue for over 50 years and is famed in Edinburgh as one of the original Fringe theatres. The space itself is a very atmospheric large thrust space located yards from the Royal Mile on Jeffrey St and almost opposite the entrance to Waverley Station. See our website for more information on awards and recent shows.



The Venue consists of an 89 seat theatre with a thrust stage performance area of 7.2m deep by 3.6m wide on ground level. The central block of seating is raised, the ceiling is 3.6m high and the space is blacked by drapes from all sides. A large dressing room is provided and set and prop storage space is available in the caverns underneath the church. There is easy access to the building from Jeffrey Street for get in and strikes.

A lighting rig of about 60 lanterns giving general cover and specials will be provided. The general cover may not be re-gelled or not refocused; but a flexible array of specials is provided that can provide spots or washes about the stage. Control will be by memory board with 24 channels and 2 manual presets. Sound equipment will include a CD player. Vocal microphones can also be provided on request.

Further details on page 8.

The Space @ Jurys



In an ideal central position just off the Royal Mile and next door to Venue 45, the Main Theatre is our development space where we focus on giving new and progressive companies the platform to gain the invaluable experience of performing on the Edinburgh Fringe.

It's an ideal theatre for the first time Edinburgh show, the 40 seat end on black box caters comfortably for 1-4 handers. The venue has developed naturally since 2002 into one offering an affordable opportunity for young theatre companies to come to Edinburgh for a long run, on a

budget and perform right at the heart of the Fringe.

The room is blacked out around the edges using floor to ceiling drapes, with access to the dressing room via the main entrance to the theatre. The venue has an intimate feel and is suited to small scale theatre, sketch, monologue performances. The stage (dimensions approx 4m x 2m) provides a comfortably large acting space for this size of venue. Ceiling height is 2.3m.

Lighting cover is via a basic stand mounted rig, with a choice of up to three washes covering the whole stage. It will be possible to re-gel the general cover. A small stereo sound system is installed complete with CD player. There will be opportunity for additional sound equipment such as mini disc, or laptop computers via spare input channels on the mixer.

Further details on page 9.

Studio Theatre

Located at our already established theSpace @ Jurys and back for 2018 after proving very popular in 2017, the Studio Theatre is an intimate 31-seat end on performance space offering a defined programme of stand-up comedy, spoken word, sketch, stand up magic and non set/prop theatre.

Further details on page 10.

theSpace @ Venue 45

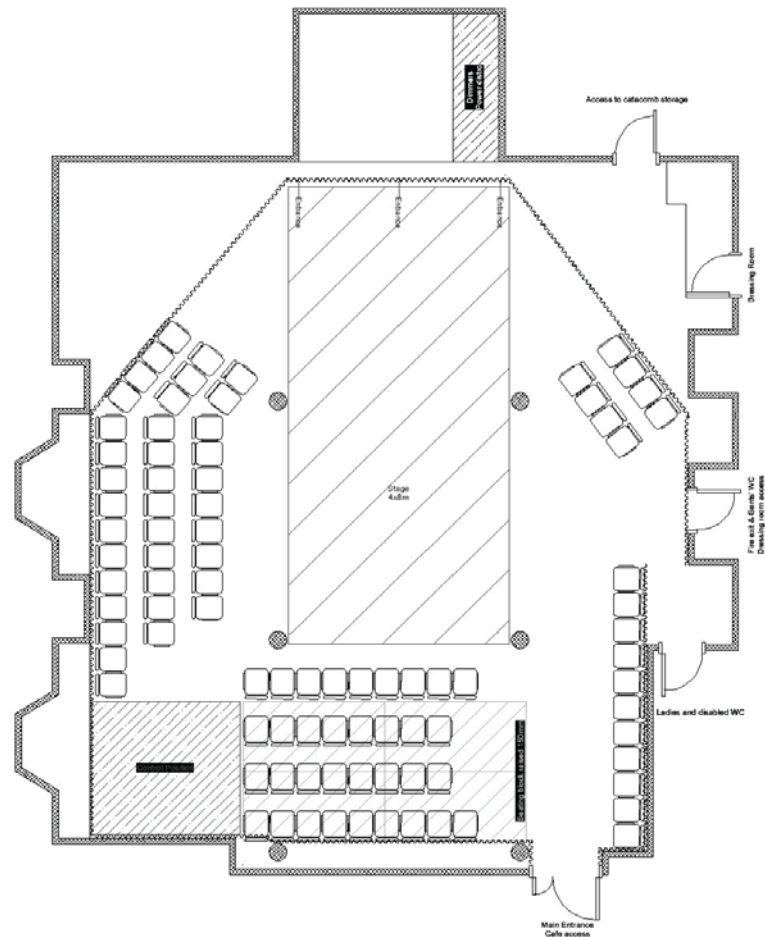

STAGE AND DRESSING ROOM

- Stage is 4m x 8m in a thrust arrangement. The acting space is within and behind the four pillars.
- Ceiling height is 3.6m to the lighting rig.
- Large dressing room available, accessible from behind stage.
- Storage space limited but can hold large/tall items.
- Auditorium seats 89 + 1.

LIGHTING

A standard rig is provided for a general cover:

- 12 x 500w Fresnels as front light
- 4 x 500w Fresnels as back light.
- 4 x 500w Fresnels as side light.

Additionally, the following specials are available:

- 4 x colour-changing LED wash lights
- 11 x 500w profiles, various beam widths.

24 channels of dimming.

The lighting desk can be run in 2-preset, submaster or fully-programmed mode.

SOUND

- CD Player.
- Folio SX mixer or similar.
- Stereo speakers and amplifier.
- Wired microphones/stands available by prior request.
- Connection for iPod/laptop.

OTHER FACILITIES

- Café in foyer area serving tea, coffee and snacks.
- Fully accessible for wheelchair users.

SMALL DETAILS OF THE TECHNICAL SPECIFICATION MAY CHANGE SLIGHTLY AS WE FINALISE OUR PLANS. IF THIS HAPPENS WE WILL LET YOU KNOW.

theSpace @ Jurys: Main Theatre

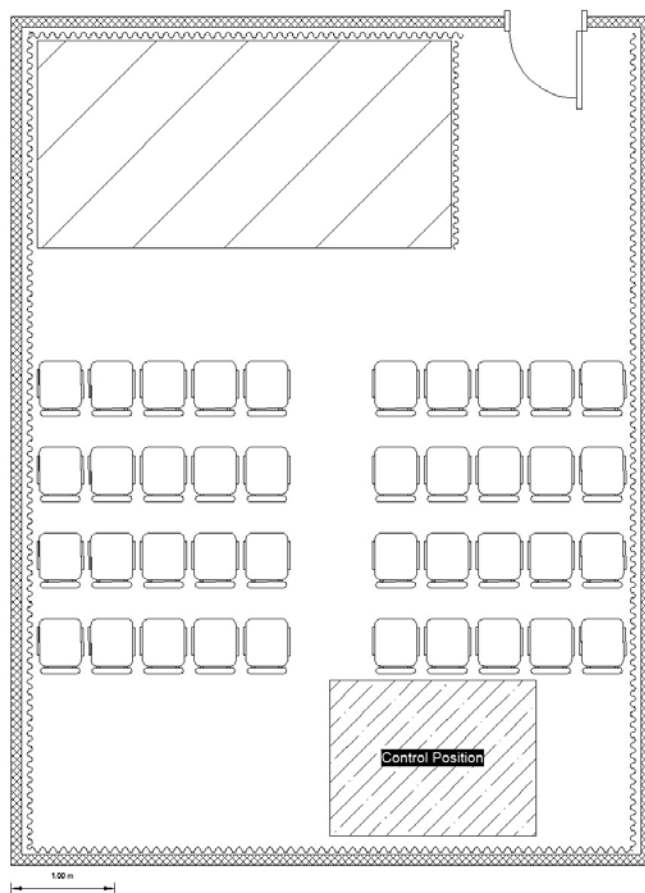

STAGE AND DRESSING ROOM

- Stage is 4m x 2m.
- Ceiling height is 2.3m.
- Adjacent dressing room accessed via the main door.
- Small storage space only suitable for small items of set and props.
- Auditorium seats 39 + 1.
- Venue is accessed by taking the lift to the 7th floor, then climbing a flight of stairs to the 8th.

LIGHTING

- 6 x 500w Fresnels rigged front-of-house.
- All lanterns may be gelled as required.
- 6 channels of dimming.
- Single preset lighting desk.

SOUND

- CD Player.
- Small mixer.
- Compact stereo speakers and amplifier.
- Wired microphones/stands available by prior request.
- Connection for iPod/laptop.

OTHER FACILITIES

- Hotel bar available on the ground floor of the building.
- Please note, due to stairs, this venue is not accessible to wheelchair users.

SMALL DETAILS OF THE TECHNICAL SPECIFICATION MAY CHANGE SLIGHTLY AS WE FINALISE OUR PLANS. IF THIS HAPPENS WE WILL LET YOU KNOW.

theSpace @ Jurys: Studio Theatre

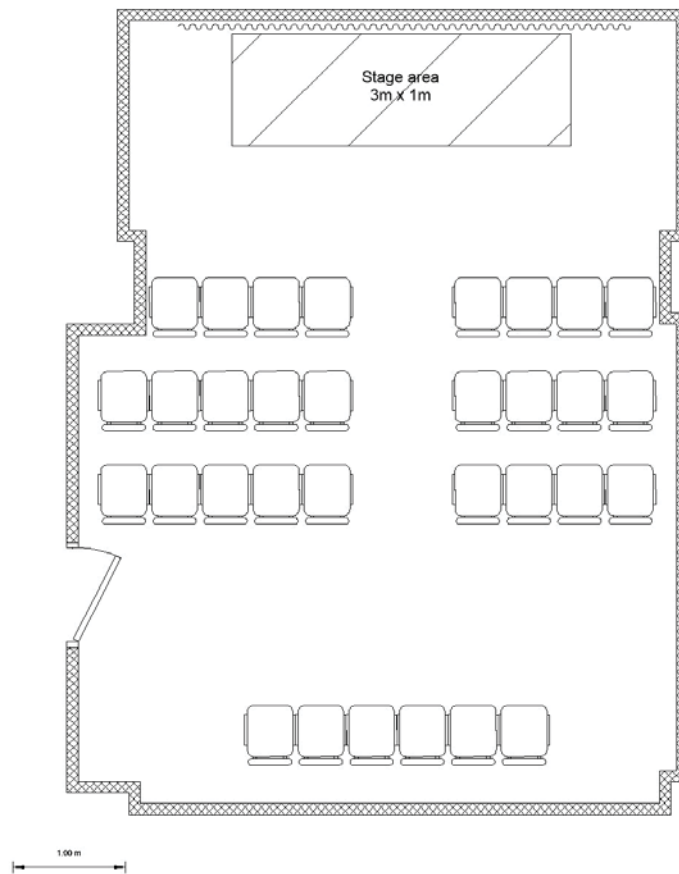

STAGE AND DRESSING ROOM

- Acting area is carpeted and is approx. 3m x 1m.
- Black drape behind acting area; rest of room is not draped.
- Ceiling height is 2.3m.
- Auditorium seats 31 + 1.
- The Studio is a very simple space and does not offer any dressing room facilities.
- We are unable to store any set or props.

LIGHTING

- 4 x 500w Fresnels rigged front-of-house.
- 4 channels of dimming.

SOUND

- Mic & stand feeding stereo powered speakers.

OTHER FACILITIES

- Hotel bar available.

SMALL DETAILS OF THE TECHNICAL SPECIFICATION MAY CHANGE SLIGHTLY AS WE FINALISE OUR PLANS. IF THIS HAPPENS WE WILL LET YOU KNOW.

theSpace on the Mile

Situated right in the middle of the Royal Mile where thousands of theatre goers gather daily this mezzanine theatre complex (part of the stylish Radisson Blu Hotel) offers an unrivalled central location. Companies performing here continue to win some of the most prestigious awards on the Fringe including Fringe First and Total Theatre Award ('Crocsmia' by Little Bulb Theatre), NSDF best ensemble and best emerging show on the Fringe ('Territory' by Fiddy West Productions) and again the NSDF Award for best show ('The Bastard Queen' Naughty Corner Productions).

We are proud to present three traditional black box studio theatres in the venue, all with their own distinctive feel. Space One with a thrust stage, Space Two with a square corner stage and Space 3 with a large end-on stage. The rooms will be blacked out around the edges using floor to ceiling drapes.

Lighting cover is via a basic scaffold- or truss-mounted rig, with a choice of lanterns covering the whole stage. The sound equipment in both venues consists of a small frame mixer and CD player, feeding a 2 channel speaker system, and there will be opportunity to connect company-provided sound equipment such as mini disc or a laptop computer.



Space One

Space One features a 5m wide by 3m deep thrust stage. Seating 52, the space is suitable for most types of theatre. The ceiling height is 2.1m above the stage area. Further details on page 12.

Space Two

Space Two is the more intimate of the two mezzanine spaces yet has an audience capacity of 55. The corner stage is 4m wide by 4m deep and is not raised. The ceiling height is 2.3m above the stage area. Further details on page 13.

Space Three

Space Three has a stage measuring 6m wide by 4m deep and an auditorium of 59 seats. Offering a traditional end-on design the space offers a flexible platform for small to mid scale performance. See page 14 for more information.



theSpace on the Mile: Space One

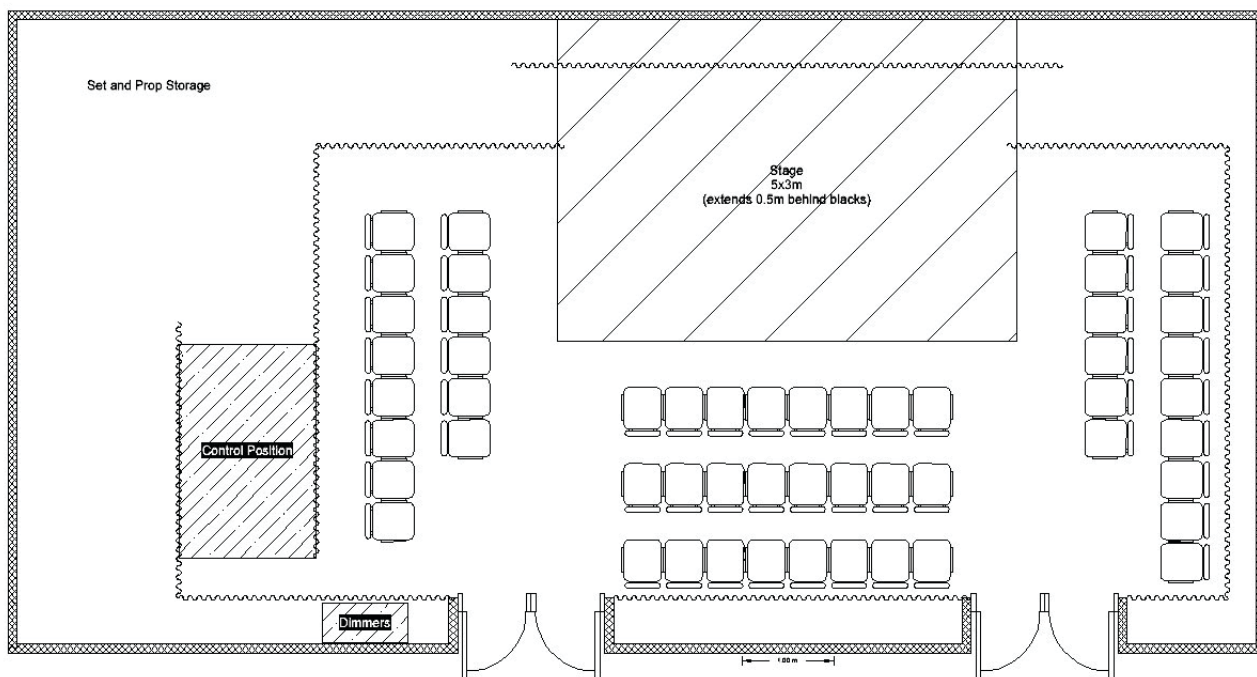

STAGE AND DRESSING ROOM

- Stage is 5m x 3m.
- Ceiling height is 2.1m above the stage.
- Small backstage space for quick changes and prop storage.
- Storage capacity in this space is limited, please talk to us with regards to your intended set and props and we will advise accordingly.
- Auditorium seats 52 + 1.

LIGHTING

- 10 x 500w Fresnels rigged front-of-house.
- 2 x 500w Fresnels rigged as back lights.
- 4 x Parcans for additional colour.
- All lanterns may be gelled as required.
- 12 channels of dimming.
- Programmable lighting desk.

SOUND

- CD Player.
- Small mixer.
- Compact stereo speakers and amplifier.
- Wired microphones/stands available by prior request.
- Connection for iPod/laptop.

OTHER FACILITIES

- Hotel bar available.

SMALL DETAILS OF THE TECHNICAL SPECIFICATION MAY CHANGE SLIGHTLY AS WE FINALISE OUR PLANS. IF THIS HAPPENS WE WILL LET YOU KNOW.

theSpace on the Mile: Space Two

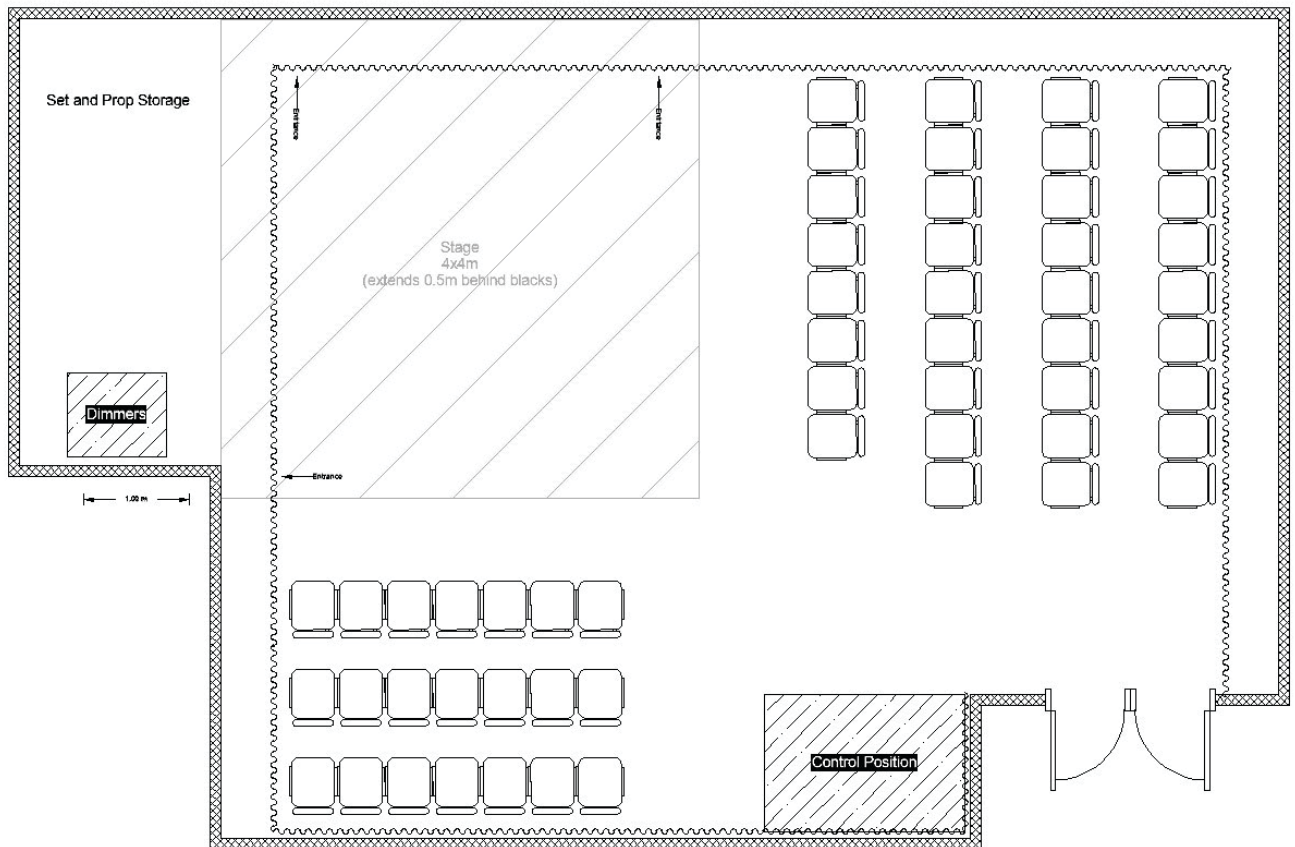

STAGE AND DRESSING ROOM

- Stage is 4m x 4m.
- Ceiling height is 2.3m above the stage.
- Small backstage space for quick changes and prop storage.
- Storage capacity in this space is limited, please talk to us with regards to your intended set and props and we will advise accordingly.
- Auditorium seats 55 + 1.

LIGHTING

- 8 x 500w Fresnels rigged front-of-house.
- 2 x 500w Fresnels rigged as back lights.
- All lanterns may be gelled as required.
- 9 channels of dimming.
- Programmable lighting desk.

SOUND

- CD Player.
- Small mixer.
- Compact stereo speakers and amplifier.
- Wired microphones/stands available by prior request.
- Connection for iPod/laptop.

OTHER FACILITIES

- Hotel bar available.

SMALL DETAILS OF THE TECHNICAL SPECIFICATION MAY CHANGE SLIGHTLY AS WE FINALISE OUR PLANS. IF THIS HAPPENS WE WILL LET YOU KNOW.

theSpace on the Mile: Space Three

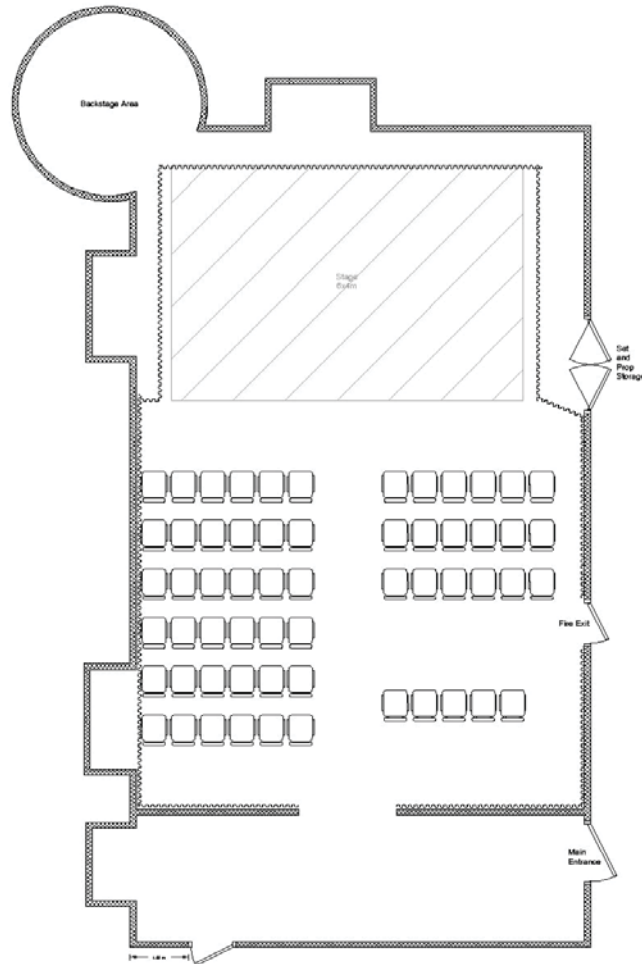

STAGE AND DRESSING ROOM

- Stage is 6m wide by 4m deep.
- Stage is raised by 0.2m.
- Ceiling clearance above the stage is approx. 2.5m to the rig.
- Small backstage space for quick changes and prop storage.
- Storage capacity in this space is limited, please talk to us with regards to your intended set and props and we will advise accordingly.
- Auditorium seats 59+1.

LIGHTING

- 8 x 500w Fresnels rigged for fixed-focus general wash (cannot be re-gelled)
- 3 x 500w Fresnels rigged as back light
- 4 x 500w Fresnels rigged as side light
- 4 x 500w profiles for face light.
- 4 x 500w profiles & 4 x 500w Fresnels for specials.
- 18 channels of dimming.
- Programmable lighting desk.

SOUND

- CD Player.
- Small mixer.
- Compact stereo speakers and amplifier.
- Wired microphones/stands available by prior request.
- Connection for iPod/laptop.

OTHER FACILITIES

- Limited backstage area for costume storage.

SMALL DETAILS OF THE TECHNICAL SPECIFICATION MAY CHANGE SLIGHTLY AS WE FINALISE OUR PLANS. IF THIS HAPPENS WE WILL LET YOU KNOW.

Our two venues at Niddry Street are both fabulous theatres in an unrivalled location next door to theSpace on the Mile and at the very hub of the bustling modern fringe where thousands of theatregoers gather daily looking for shows to see.

Known for mid- to large-scale theatre, musicals, a-capella and dance, the theatres have been a firm favourite with performing companies and audiences since their inception in 2009.

The Upper theatre offers either a spectacular 92-seat in-the-round design or a 73-seat thrust alternative, whilst the Lower space is a 102-seat raked thrust.

Outside there is a busy courtyard theatre bar, perfect for a pre- or post-show drink.

Lower Theatre

The Lower theatre seats 102 and the audience is on three sides of the 8m wide by 4.5m deep thrust stage. The stage itself is at floor level and the clearance above it is at least 2.5m.

The rear rows of seats are raised to create an amphitheatre feel for the venue.

The lighting rig is simple yet effective and should prove adequate for simple designs. The sound rig is a full-range system designed for music.

Further information is on page 16.

Upper Theatre

Niddry Upper is a unique in-the-round or thrust theatre with a 5x5m stage seating 92 (in the round) or seating 73 (thrust). The seating is in an amphitheatre style arrangement and the stage is flat on the floor.

Further information is on page 17.



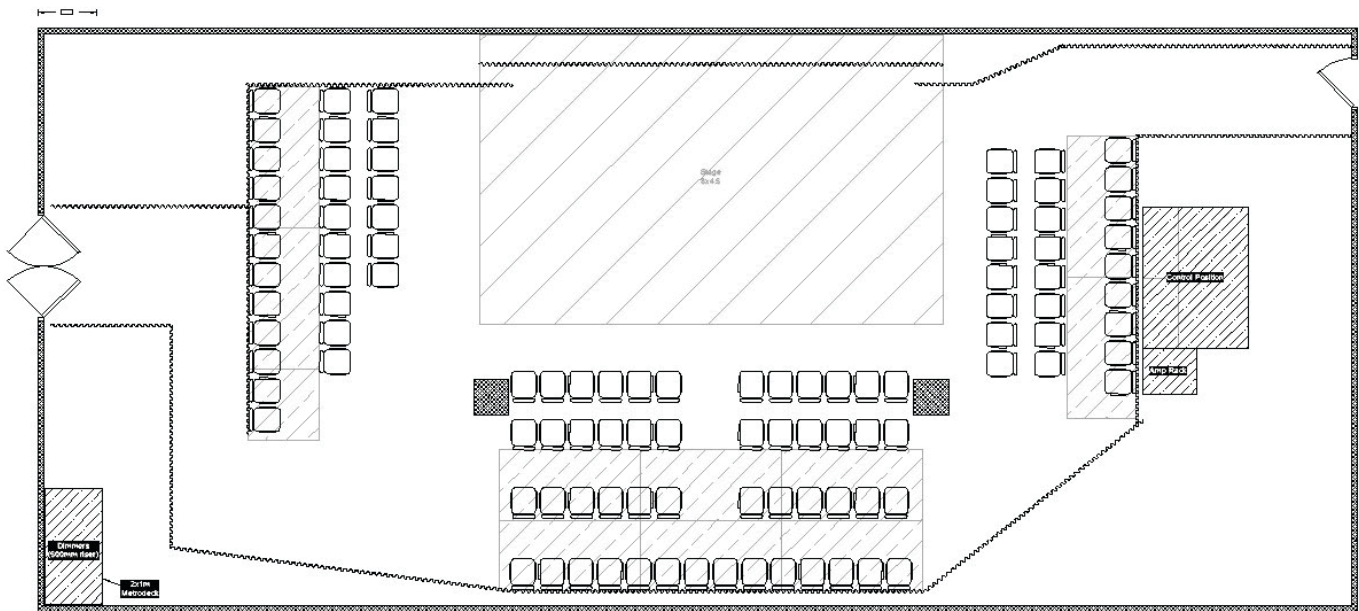

STAGE AND DRESSING ROOM

- Stage is 8m x 4.5m.
- Stage is at floor level. Rear row of seating is raised to create an amphitheatre feel to the venue.
- Ceiling height is at least 2.5m above the stage.
- Small backstage space for quick changes and prop storage.
- Auditorium seats 102 + 2.

LIGHTING

- Conventional lighting rig using small 650W Fresnels/profiles and 500w parcans.
- Suitable for simple productions requiring washes and a bit of colour.
- 2-preset manual lighting desk.
- 24 channels of dimming.

SOUND

- CD Player.
- Small mixer.
- Full-range musical speaker system.
- Wired microphones/stands available by prior request.
- Connection for iPod/laptop.

OTHER FACILITIES

- Direct access from Niddry Street.
- Hotel bar.

SMALL DETAILS OF THE TECHNICAL SPECIFICATION MAY CHANGE SLIGHTLY AS WE FINALISE OUR PLANS. IF THIS HAPPENS WE WILL LET YOU KNOW.

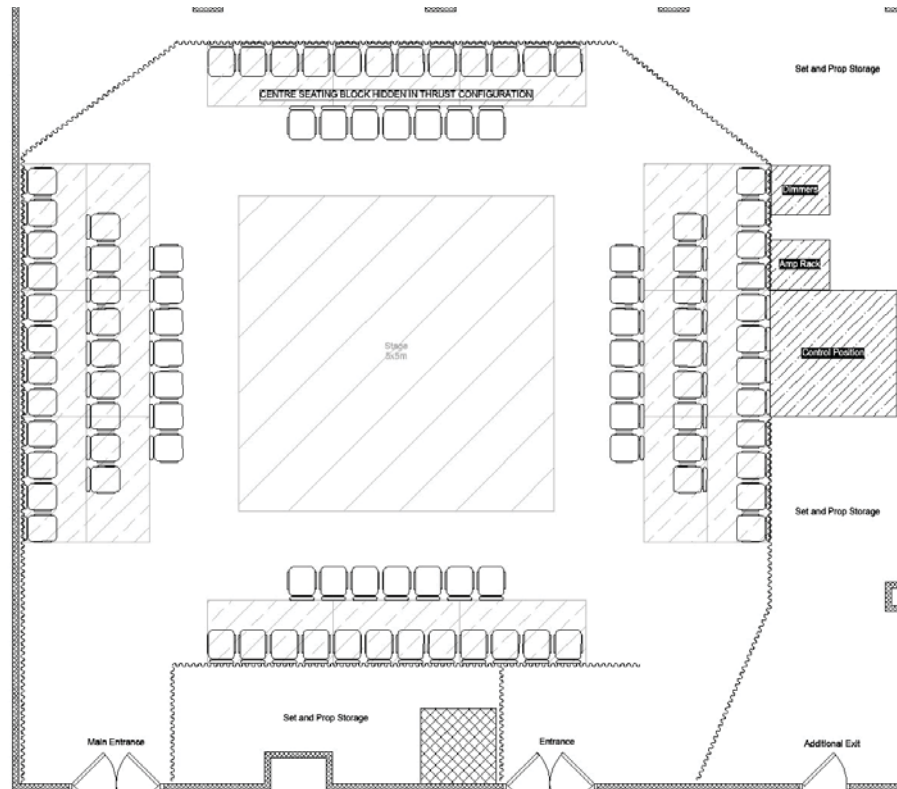

STAGE

- Stage is 5m x 5m
- Fully in the round; audience on 4 sides seats 92 + 2 (one FOH manager and one usher).
- Thrust option available; audience on 3 sides (one seating block masked off) to seat 73 + 2.
- Stage is at floor level. Rear 1-2 rows of seating are raised to create an amphitheatre feel.
- Ceiling height is at least 2.5m above the stage.
- Small backstage space for quick changes and prop storage.

LIGHTING

- Conventional lighting rig using Source Four Par-nels and small profiles.
- LED parcans provide a secondary wash and/or bash in some colour.
- Suitable for simple productions requiring washes and a bit of colour.
- 24 channels of dimming.
- Programmable lighting desk.

SOUND

- CD Player.
- Small mixer.
- Lightweight musical speaker system, designed for SFX and music playback.
- Wired microphones/stands available by prior request.
- Connection for iPod/laptop.

OTHER FACILITIES

- Direct access from Niddry Street.
- Hotel bar.

SMALL DETAILS OF THE TECHNICAL SPECIFICATION MAY CHANGE SLIGHTLY AS WE FINALISE OUR PLANS. IF THIS HAPPENS WE WILL LET YOU KNOW.

theSpace on North Bridge

After a triumphant return to theSpace on North Bridge for the 2017 festival, our all-new spaces are back for another year but with a little more!

Located right at the heart of the festival, opposite our theatres at theSpace on the Mile and theSpace @ Niddry and on the corner of the Royal Mile, Nicholson Street and North Bridge, our venue at the Hilton Edinburgh Carlton Hotel is literally seconds from the outdoor fringe stages where the throng of the festival beats strongest.

Our venue complex features three intimate performance spaces ideally suited to all forms of fringe festival performance genre from theatre to monologues, sketch, and improv. Conveniently situated adjacent to the Hotel's bar and lounge, our venues are neatly tucked away in our own little world of the Fringe and yet at the same time are right in the heart of the city.

The Argyll & Perth Theatres

Our two venues on North Bridge are close to identical, intimate thrust spaces with large stages and seating 50. Both spaces cater for theatre companies with up to 12 performers.

Further details on the Argyll Theatre are on page 19 and the Perth Theatre on page 20.

The Fife Theatre

New for 2018, our new Fife Theatre could not be closer to the Royal Mile (it's overlooking it!). A modest yet flexible 40-seater end-on space with a large stage.

More details on page 21.



theSpace on North Bridge: The Argyll Theatre

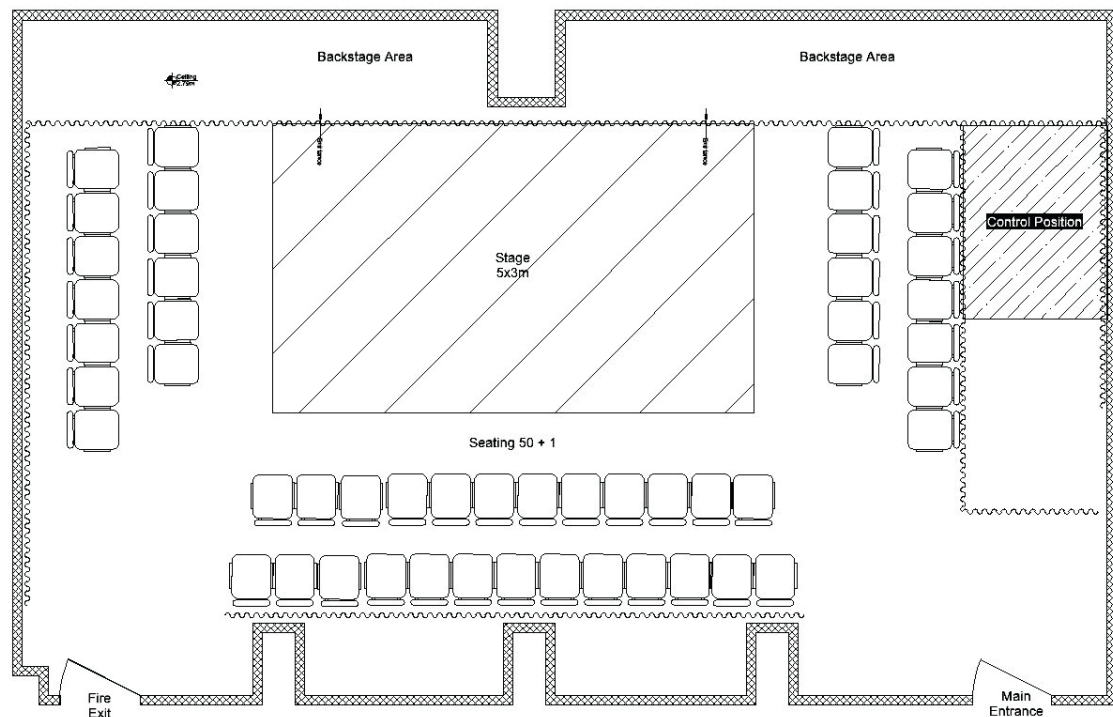

STAGE AND DRESSING ROOM

- Stage size 5x3m
- Stage is flat on the floor with a small 2cm raise.
- Ceiling clearance above the stage is approx. 2.7m.
- Small backstage space for quick changes and prop storage.
- Storage capacity in this space is limited, please talk to us with regards to your intended set and props and we will advise accordingly.
- Auditorium seats 50 + 1 FOH

LIGHTING

LED-based lighting rig comprising:

- Briteq BT-THEATRE 100EC LED fresnels.
- ETC LUSTR+ LED Source 4 profiles.
- Lanta Fireball (or similar) LED PAR 64s.
- Programmable desk.

SOUND

- CD Player.
- Small mixer.
- Compact stereo speakers and amplifier.
- Wired microphones/stands available by prior request.
- Connection for iPod/laptop.

OTHER FACILITIES

- Adjacent set/prop storage area (shared between Argyll and Perth theatres).
- Hotel bar adjacent to our box office.

SMALL DETAILS OF THE TECHNICAL SPECIFICATION MAY CHANGE SLIGHTLY AS WE FINALISE OUR PLANS. IF THIS HAPPENS WE WILL LET YOU KNOW.

theSpace on North Bridge: The Perth Theatre

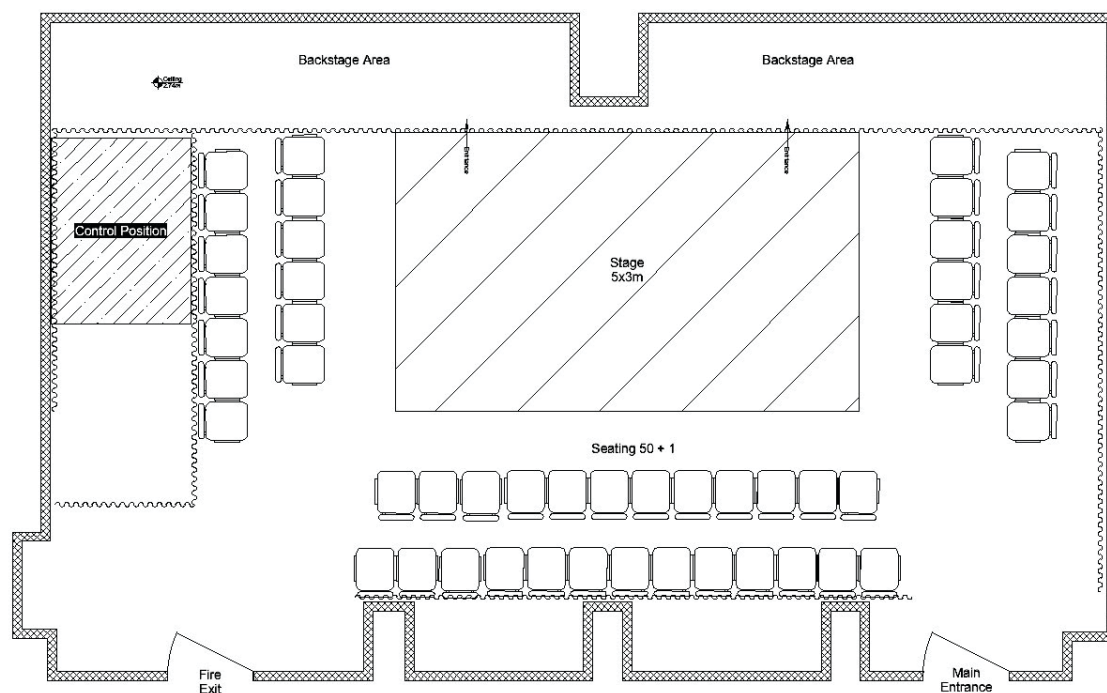

STAGE AND DRESSING ROOM

- Stage size 5x3m
- Stage is flat on the floor with a small 2cm raise.
- Ceiling clearance above the stage is approx. 2.7m.
- Small backstage space for quick changes and prop storage.
- Storage capacity in this space is limited, please talk to us with regards to your intended set and props and we will advise accordingly.
- Auditorium seats 50 + 1 FOH

LIGHTING

LED-based lighting rig comprising:

- Briteq BT-THEATRE 100EC LED fresnels.
- ETC LUSTR+ LED Source 4 profiles.
- Lanta Fireball (or similar) LED PAR 64s.
- Programmable desk.

SOUND

- CD Player.
- Small mixer.
- Compact stereo speakers and amplifier.
- Wired microphones/stands available by prior request.
- Connection for iPod/laptop.

OTHER FACILITIES

- Adjacent set/prop storage area (shared between Argyll and Perth theatres).
- Hotel bar adjacent to our box office.

SMALL DETAILS OF THE TECHNICAL SPECIFICATION MAY CHANGE SLIGHTLY AS WE FINALISE OUR PLANS. IF THIS HAPPENS WE WILL LET YOU KNOW.

theSpace on North Bridge: The Fife Theatre

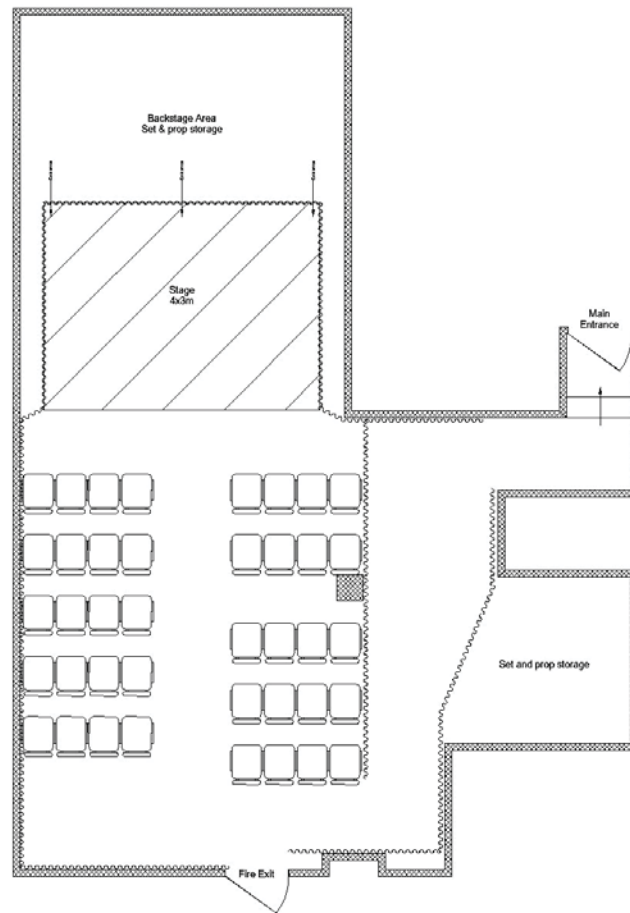

STAGE AND DRESSING ROOM

- Stage size 4x3m
- Stage is c. 10cm raised.
- Ceiling clearance above the stage is approx. 2.3m.
- Small backstage space for quick changes and prop storage.
- Storage capacity in this space is limited, please talk to us with regards to your intended set and props and we will advise accordingly.
- Auditorium seats 40 + 1 FOH

LIGHTING

LED-based lighting rig comprising:

- Briteq BT-THEATRE 100EC LED fresnels.
- ETC LUSTR+ LED Source 4 profiles.
- Lanta Fireball (or similar) LED PAR 64s.
- Programmable desk.

SOUND

- CD Player.
- Small mixer.
- Compact stereo speakers and amplifier.
- Wired microphones/stands available by prior request.
- Connection for iPod/laptop.

OTHER FACILITIES

- Hotel bar adjacent to our box office.

SMALL DETAILS OF THE TECHNICAL SPECIFICATION MAY CHANGE SLIGHTLY AS WE FINALISE OUR PLANS. IF THIS HAPPENS WE WILL LET YOU KNOW.

After another successful year hosting some 80 shows at this wonderful venue we return to present four superb state of the art theatre spaces. Located on Nicholson Street, opposite the Royal Festival Theatre, two minutes from the Royal Mile and yards from Bristo Square, our venue complex is located within the beautiful Quincentenary Hall Complex at the historic Royal College of Surgeons.

The complex is set back from the road and features a spacious private theatre courtyard serving food and drinks, a modern spacious box office and reception facility and four fully facilitated performance spaces.

Ground Floor

There are three spaces on the ground floor, Theatres 1, 2 and 3, which are accessible directly from the reception / box office. Catering for shows with small sets and audiences up to 55, these theatres are ideally suited to theatre, monologues and comedy.

In all three spaces lighting cover is via a basic rig mounted on truss or around the edge of the room. Although simple, the rig allows a choice of washes covering the whole stage. It will be possible to re-gel any lanterns in the rig to your requirements. There will be opportunity for additional sound equipment such as mini disc, or laptop computers via spare input channels on the mixer. Two microphones with stands are available in each space.



Theatre 1

Theatre 1 is a uniquely-designed corner space ideally suited to shows with casts of up to 6 people and a small amount of set. The venue caters for an audience of 55.

The corner stage is raised by approximately 0.1m. A small backstage space behind allows for set/prop storage. Access is provided behind the blacks to entrances on either side of the stage. Ceiling clearance over the stage is approximately 2.4m. Further details on page 24.

Theatre 2

Theatre 2 is a small but traditional space ideally suited to shows with casts of up to 6 people and a small amount of set. The venue caters for an audience of 49.

The stage is raised by 0.2m. A small backstage space behind allows for set/prop storage. Access is provided behind the blacks to entrances on either side of the stage. Ceiling clearance over the stage is approximately 2.2m. Further details on page 25.

Theatre 3

Theatre 3 is a small space ideally suited to shows with casts of up to 4 people and a small amount of set. The venue caters for an audience of 42.

The rectangular stage is raised by 0.2m. A small backstage space behind allows for set/prop storage. Access is provided behind the blacks to entrances on either side of the stage. Ceiling clearance over the stage is approximately 2.2m. Further details on page 26.

First Floor - The Grand

The Grand Theatre is a generously equipped large theatre venue ideally suited to shows with large casts or sets. The venue caters for an audience of 119 so is suitable for large scale popular shows.

The Theatre consists of a generously sized flat stage (7.5x4.0m) in a creative thrust formation. The grid clearance over the stage is approximately 3.0m, although in places some lanterns might hang lower. Black drapes are rigged at the back of the stage. A green room area is available in an adjacent room with access to the stage.

The lighting rig is designed with two fixed general washes and a set of specials which can be re-gelled and focussed to your requirements. The rig has 36 channels of dimming and is controlled by a memory lighting desk.

The sound equipment consists of a mixer and CD player, feeding a full range speaker system designed for musical theatre. There will be opportunity to connect your own additional sound equipment such as mini disc, laptop computer or radio microphone systems via spare input channels on the mixer.

Further details on page 27.



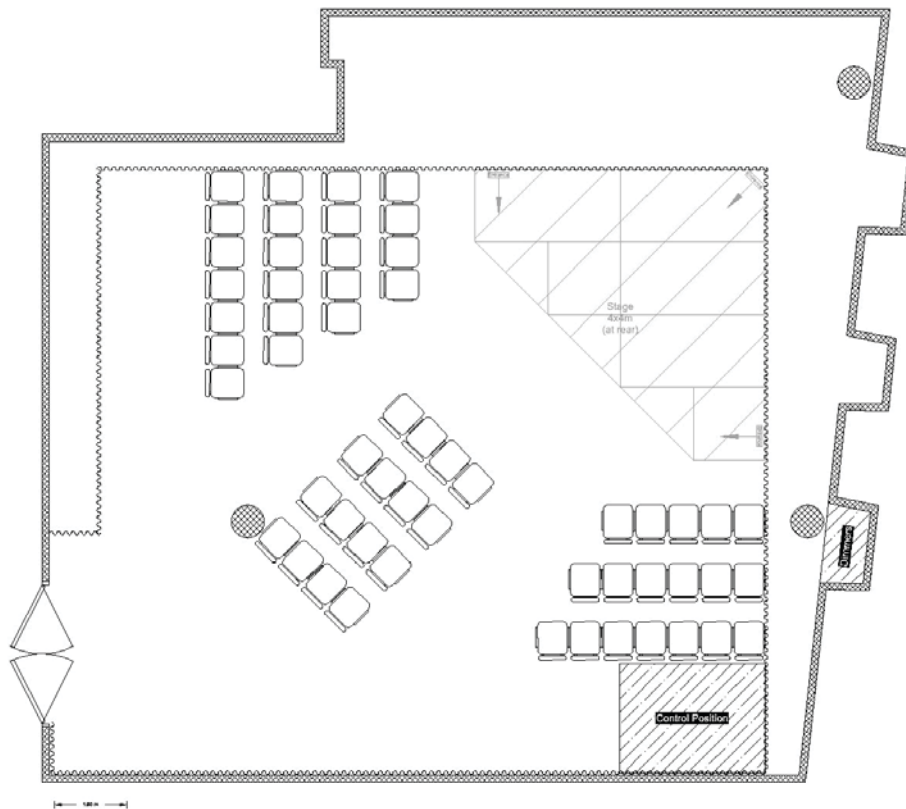

STAGE AND DRESSING ROOM

- Corner stage is 4.5m on both sides.
- Stage is raised approximately 0.1 m.
- Ceiling clearance above the stage is about 2.4m.
- Storage space is very limited, please bring small items of set and props only.
- Auditorium seats 55 + 1.

LIGHTING

- 6 x 500w Fresnels rigged for general wash and back light.
- 3 x 500w narrow profiles rigged as face lights.
- All lanterns may be gelled as required.
- 9 channels of dimming.
- Programmable lighting desk.

SOUND

- CD Player.
- Small mixer.
- Compact stereo speakers and amplifier.
- Wired microphones/stands available by prior request.
- Connection for iPod/laptop.

OTHER FACILITIES

- Courtyard bar & BBQ.
- Cloakroom area for costume storage (shared between Theatres 1, 2 and 3).

SMALL DETAILS OF THE TECHNICAL SPECIFICATION MAY CHANGE SLIGHTLY AS WE FINALISE OUR PLANS. IF THIS HAPPENS WE WILL LET YOU KNOW.

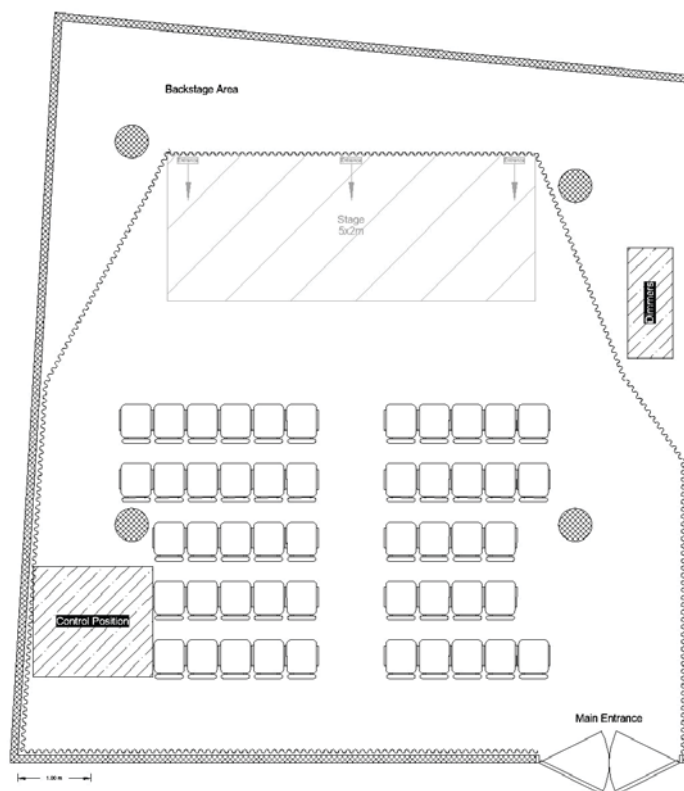

STAGE AND DRESSING ROOM

- Stage is 5m wide by 2m deep.
- Stage is raised by 0.2m.
- Ceiling clearance above the stage is about 2.2m.
- Storage space is very limited, please bring small items of set and props only.
- Auditorium seats 49 + 1.

LIGHTING

- 6 x colour-changing LED Fresnels rigged for general wash
- 2 x colour-changing LED Fresnels rigged as back light.
- 2 x 500w profiles which may be gelled as required.
- 3 channels of dimming for profiles and house lights; LEDs can also be dimmed.
- Programmable lighting desk.

SOUND

- CD Player.
- Small mixer.
- Compact stereo speakers and amplifier.
- Wired microphones/stands available by prior request.
- Connection for iPod/laptop.

OTHER FACILITIES

- Courtyard bar & BBQ.
- Cloakroom area for costume storage (shared between Theatres 1, 2 and 3).

SMALL DETAILS OF THE TECHNICAL SPECIFICATION MAY CHANGE SLIGHTLY AS WE FINALISE OUR PLANS. IF THIS HAPPENS WE WILL LET YOU KNOW.

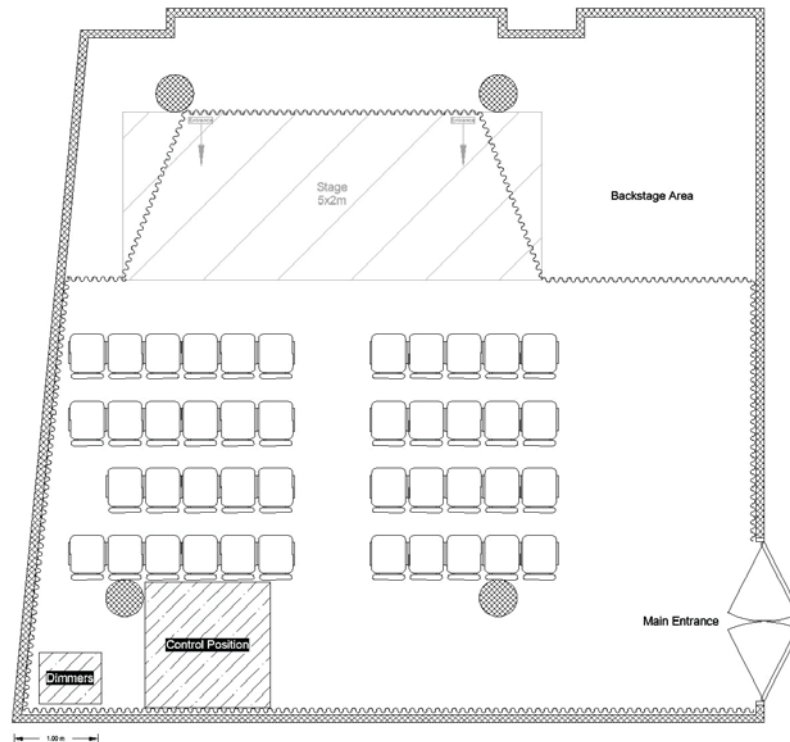

STAGE AND DRESSING ROOM

- Stage is 5m wide by 2m deep.
- Stage is raised by 0.2m.
- Ceiling clearance above the stage is about 2.2m.
- Storage space is very limited, please bring small items of set and props only.
- Auditorium seats 42 + 1.

LIGHTING

- 6 x colour-changing LED Fresnels rigged for general wash
- 2 x colour-changing LED Fresnels rigged as back light.
- 2 x 500w profiles which may be gelled as required.
- 3 channels of dimming for profiles and house lights; LEDs can also be dimmed.
- Programmable lighting desk.

SOUND

- CD Player.
- Small mixer.
- Compact stereo speakers and amplifier.
- Wired microphones/stands available by prior request.
- Connection for iPod/laptop.

OTHER FACILITIES

- Courtyard bar & BBQ.
- Cloakroom area for costume storage (shared between Theatres 1, 2 and 3).

SMALL DETAILS OF THE TECHNICAL SPECIFICATION MAY CHANGE SLIGHTLY AS WE FINALISE OUR PLANS. IF THIS HAPPENS WE WILL LET YOU KNOW.

theSpace @ Surgeons' Hall: The Grand Theatre

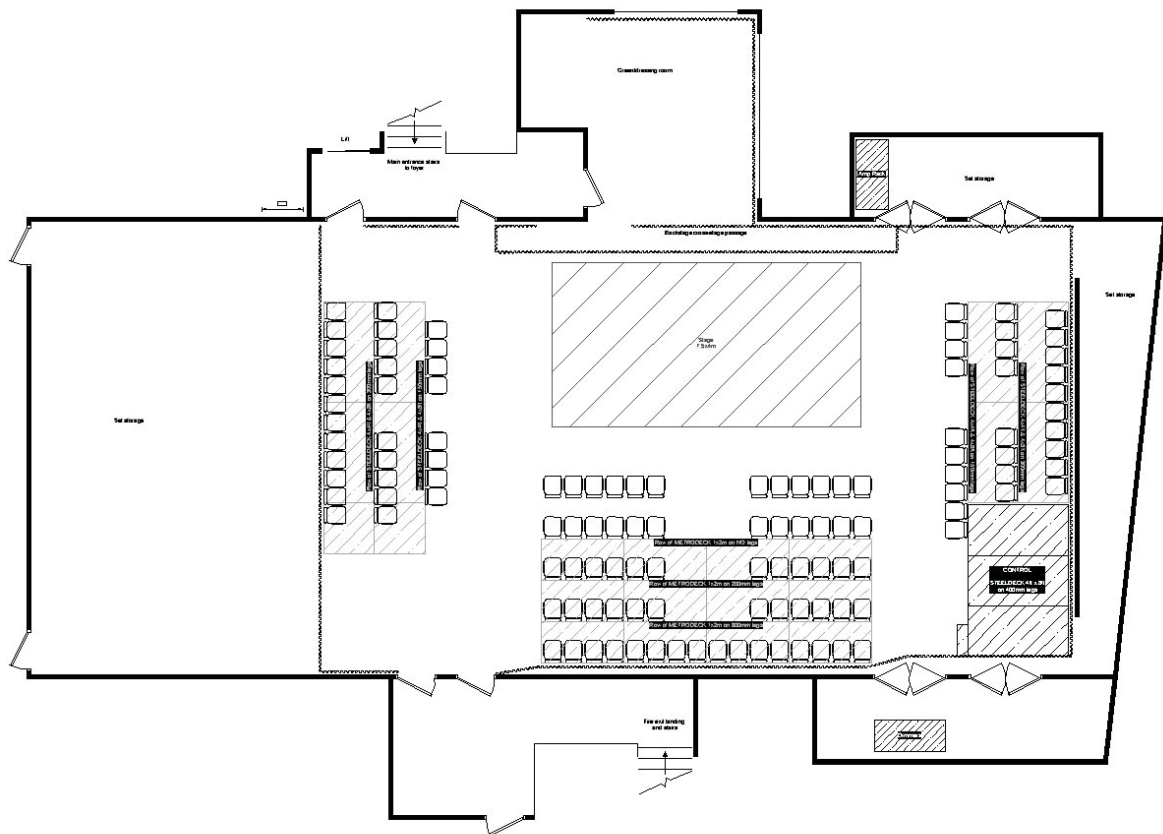

STAGE AND DRESSING ROOM

- Stage is 7.5m x 4.0m, and is not raised. It is approx. 2cm thick so there is a slight step up.
- Grid clearance above the stage is about 3.0m.
- Backstage & storage space suitable for large items of scenery.
- Auditorium seats 119+2

LIGHTING

- 36 channels of dimming.
- The lighting desk can be run in 2-preset, sub-master or fully-programmed mode.
- 10 x 1000W Fresnels for warm general cover (may not be re-gelled)
- 6 x 1000W Fresnels for cold general cover (may not be re-gelled)
- 3 x 1000W Fresnels as back light.
- 12 x 500w Fresnels as side light.
- 13 x 575w profiles, various beam angles.
- 14 x 1000w Parcans

SOUND

- CD Player.
- Large mixer.
- Full-range musical speaker system.
- Wired microphones/stands available by prior request.
- Connection for iPod/laptop.

OTHER FACILITIES

- Courtyard bar & BBQ.

SMALL DETAILS OF THE TECHNICAL SPECIFICATION MAY CHANGE SLIGHTLY AS WE FINALISE OUR PLANS. IF THIS HAPPENS WE WILL LET YOU KNOW.

theSpace Triplex

theSpace Triplex is a unique new venue, located at the hub of the festival where Hill Place meets Nicholson St, next door to theSpace @ Surgeons' Hall and across the road from Assembly Roxy and Bristo Square. The venue offers 3 floors, unique performance spaces and a social hub offering daily events and a late night music/cabaret showcases.

Triplex Big

We don't mess about. We called it Big because that's what it is! Big is our stellar performance space, back again for 2018. It's a large black box configured as a large 8x5m floor stage with 130 seats and two rows of raised seating. The truss grid is 4m high and the apex of the arched roof above is easily as high again; it's a veritable cathedral to the performing arts.

Further details on page 29.

Triplex Studio

Smaller yet perfectly formed, Triplex Studio is a 63 seat thrust theatre. The stage of 4x3m makes it the perfect venue for small/mid scale theatre, sketch, spoken word, cabaret, comedy, stand-up and music.

Further details on page 30.



theSpace Triplex: Big

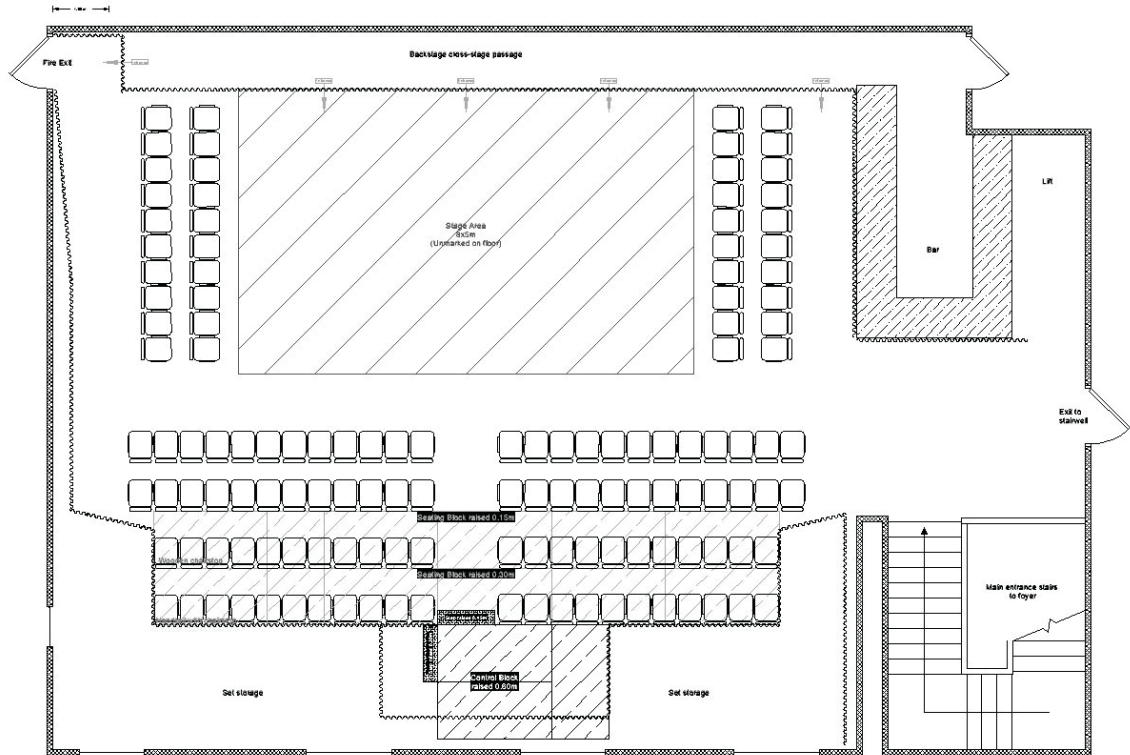

STAGE

- Stage is an 8x5m floor-based performance area
- Small backstage space for quick changes and prop storage.
- Auditorium seats 130+2 with the two rear rows raked.
- Talk to us if you wish to use the theatre in an end-on configuration with the side seating removed.

LIGHTING

- A 4m high truss grid holds a basic yet flexible rig of conventional wash and spot lights, suitable for all types of performance.
- LED parcans for colour.
- Programmable lighting desk.

SOUND

- CD Player.
- 24-channel analogue mixer.
- Full-range musical speaker system, designed for SFX, music playback and live sound.
- Wired microphones/stands and DIs available by prior request.
- Connection for iPod/laptop.

OTHER FACILITIES

- Bar serving drinks and refreshments on the ground floor of the SpaceTriplex complex.
- This space has a bar within, available by prior arrangement.

SMALL DETAILS OF THE TECHNICAL SPECIFICATION MAY CHANGE SLIGHTLY AS WE FINALISE OUR PLANS. IF THIS HAPPENS WE WILL LET YOU KNOW.

theSpace Triplex: Studio

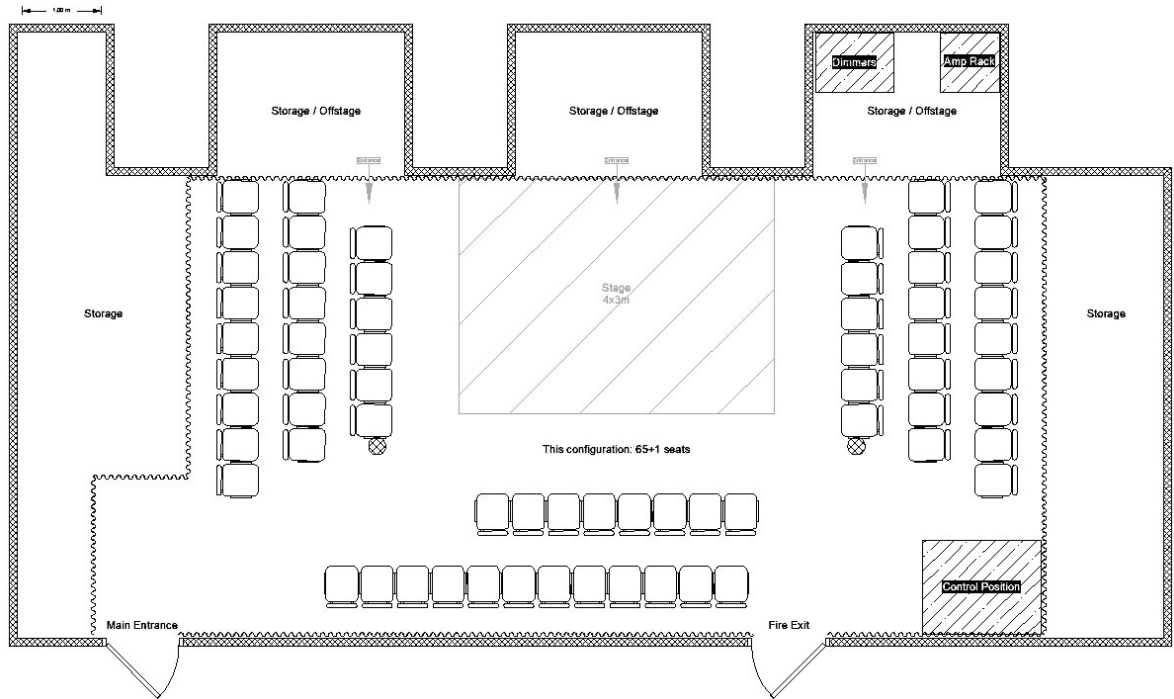

STAGE

- Stage is 4m x 3m
- Audience on 3 sides.
- Stage is at floor level.
- Ceiling height is at least 2.2m above the stage.
- Small backstage space for quick changes and prop storage.
- Auditorium seats 63 + 2.

LIGHTING

- Stage is lit with LED fresnels which can create a wash in any colour you choose.
- LED parcans add a bit of additional colour.
- Centre-stage traditional spotlight.
- Programmable lighting desk.

SOUND

- CD Player.
- Small mixer.
- Lightweight musical speaker system, designed for SFX and music playback.
- Wired microphones/stands available by prior request.
- Connection for iPod/laptop.

OTHER FACILITIES

- Bar serving drinks and refreshments on the ground floor of the SpaceTriplex complex.

SMALL DETAILS OF THE TECHNICAL SPECIFICATION MAY CHANGE SLIGHTLY AS WE FINALISE OUR PLANS. IF THIS HAPPENS WE WILL LET YOU KNOW.



theSpace @ Symposium is a very high calibre venue. This wonderful space is in a converted church located between the Pleasance and Bristo Square and right next door to theSpace @ Surgeons Hall. It offers a fantastic custom built 156 seat amphitheatre.

Here we programme an array of Choral, Stand Up, Comedy, Music, Musical theatre, Interactive and Cabaret shows. In recent years the acclaimed Amused Moose Comedy heats and awards have been held here and the venue boasts an a-capella festival all of its own with some of the countries most established groups making this their festival home.

The venue boasts a built in sound desk, fixed projector and over-stage screen as well as an automated voting system (on request) in each of the 156 leather upholstered seats. Audiences really can settle down into the most comfortable seats in one of the best located and most stylish theatres on the Fringe.

The venue also boasts a formal green room and bar and an external courtyard where audiences relax pre and post show.

theSpace @ Symposium Hall

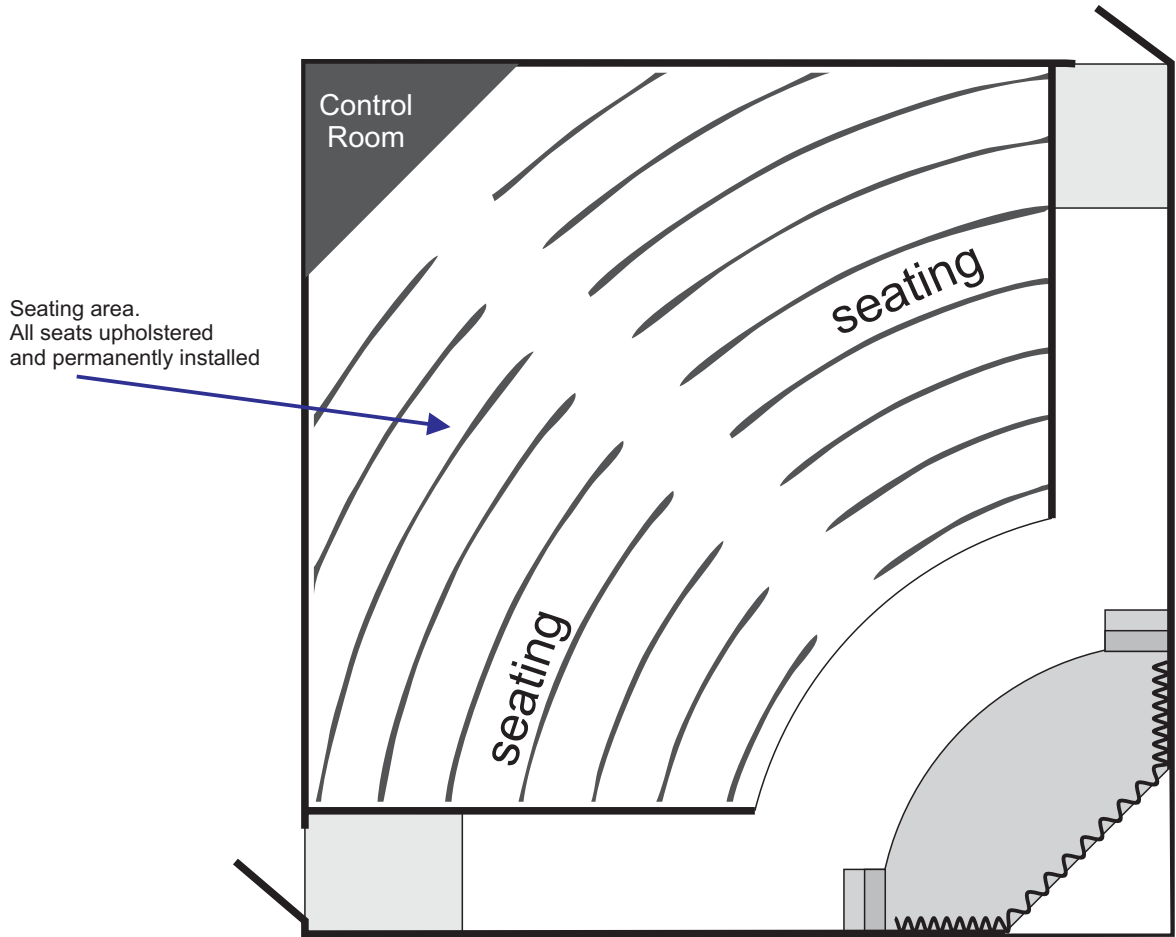

STAGE AND DRESSING ROOM

- Stage is curved, approximately 7m x 3m at its widest, 4m along the back, and is raised 0.4m.
- Ceiling clearance above the stage is about 5m.
- Very limited storage space; the venue is not suitable for sets or large quantities of props.
- Auditorium seats 156 + 2.

LIGHTING

- Lighting rig is very simple and is only intended to light the stage. 6 x Source 4 profile spots are mounted at the rear of the auditorium.
- 6 channels of dimming controlled by a 2-preset manual desk.

AUDIO/VISUAL

- The venue is equipped for AV, including a video projector, motorised screen, DVD playback and connection for laptops.

SOUND

- CD Player.
- Digital mixing console.
- Full-range musical speaker system.
- Small number of wired and wireless microphones and stands available by prior request.
- Connection for iPod/laptop.

OTHER FACILITIES

- Foyer bar.
- Courtyard bar serving food in adjacent Surgeons Hall complex.

SMALL DETAILS OF THE TECHNICAL SPECIFICATION MAY CHANGE SLIGHTLY AS WE FINALISE OUR PLANS. IF THIS HAPPENS WE WILL LET YOU KNOW.